

FIRST FLOOR

SCALE: 1/4"=1'-0"

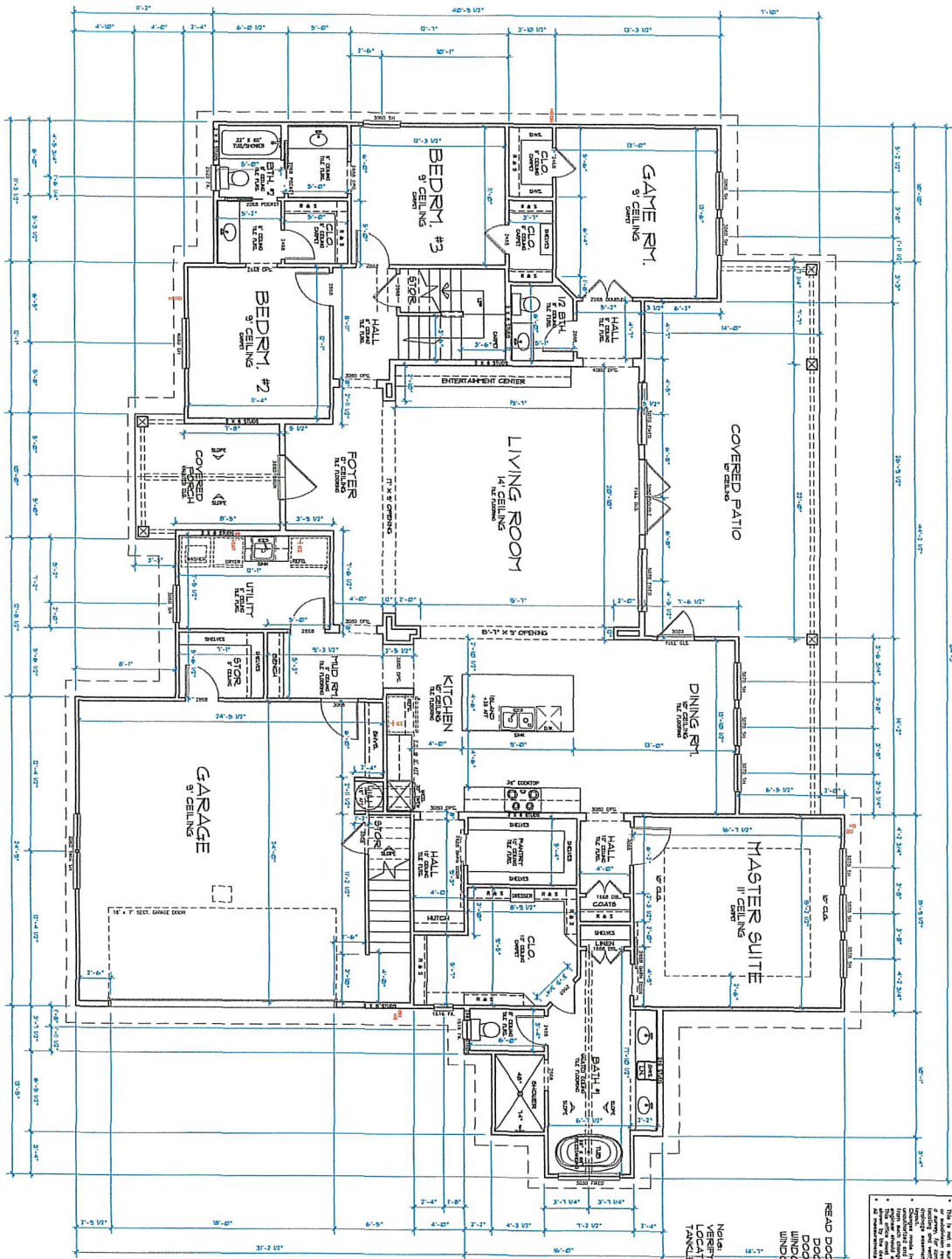

READ DOOR & WINDOWS AS FEET & INCHES
 DOOR - 2868 x 7'-8" x 6'-8"
 DOOR - 3080 x 3'-0" x 6'-8"
 WINDOW - 3050 x 3'-0" x 5'-0"
 WINDOW - 4070 x 4'-0" x 7'-0"

Note:
 1. L.I.A.C. & WATER LEAKERS
 2. LOCATION IN ATTIC FOR ELECTRIC
 TANKLESS WATER HEATER

All materials and assemblies...
 The contractor shall be responsible for...
 The contractor shall be responsible for...
 The contractor shall be responsible for...
 The contractor shall be responsible for...

© Copyright 2019 R.D. Chaplin & Associates

1 OF 3

New Residence for
 Mr. & Mrs. Machlicek
 Bell County, Texas
 Date: 01/07/20

R.D. Chaplin
 and Associates
 1614 W. Ave. L - TEMPLE, Texas, 76784
 Office: (254)-773-3025 Mobile: (254)-718-0418
 Email: rdhomeplans@gmail.com

F.F. LIV.	2,663 SQFT
F.F. GAR.	247 SQFT
TOTAL LIV.	2,940 SQFT
GARAGE	660 SQFT
PORCHES	597 SQFT
SLABS	1,285 SQFT
TOTAL	4,217 SQFT